

JB GRP Junction Boxes

Product Features

- UV stabilized watertight design
- Incorporate Ex e terminals for power & instrumentation
- Metric, NPT, PF Threads
- Hinged type door available as option
- Compliances - KCs, IECEx & ATEX



Technical Data

| | |
|------------------------------|--|
| Marking acc. to ATEX | Ⓔ II 2GD Ex e IIC T6/T5 Gb; Ex e ia IIC T6/T5 Gb; Ex ia IIC T6/T5 Gb Ex tb IIIC T85°C/100°C Db IP66 |
| Marking acc. to IECEx | Ex e IIC T6/T5 Gb; Ex e ia IIC T6/T5 Gb; Ex ia IIC T6/T5 Gb Ex tb IIIC T85°C/100°C Db IP66 |
| Ambient temp. | -40°C ~ +45°C / 55°C |
| Degree of protection | IP66 |
| Earth connection | 6m ² , 10m ² |
| Enclosure material | Glass-Fiber Reinforced polyester(Black/Gray) |
| Terminal connection | Up to 70m ² |
| Material | Body- Glassfiber reinforced polyester Cover - Glassfiber reinforced polyester Pull handle - Stainless steel Gasket - Silicon rubber Door hinge - Engineering plastic Back plate - Sheet steel/Stainless steel |
| Power | Max. 300m ² |
| Cable entry | Up to PF/NTP 4", M40 |

JB GRP Junction Boxes

Technical Data

| Model No. | Ex type | Rating | Ingress Protection |
|-----------|--|-----------------|--------------------|
| JB150 | ⊕ II 2GD Ex e IIC T6/T5 Gb; Ex e ia IIC T6/T5 Gb; Ex ia IIC T6/T5 Gb Ex tb IIIC T85°C/100°C Db IP66 | Max. 600V, 32A | IP66 |
| JB195 | ⊕ II 2GD Ex e IIC T6/T5 Gb; Ex e ia IIC T6/T5 Gb; Ex ia IIC T6/T5 Gb Ex tb IIIC T85°C/100°C Db IP66 | Max. 600V, 43A | IP66 |
| JB360 | ⊕ II 2GD Ex e IIC T6/T5 Gb; Ex e ia IIC T6/T5 Gb; Ex ia IIC T6/T5 Gb Ex tb IIIC T85°C/100°C Db IP66 | Max. 600V, 73A | IP66 |
| JB560 | ⊕ II 2GD Ex e IIC T6/T5 Gb; Ex e ia IIC T6/T5 Gb; Ex ia IIC T6/T5 Gb Ex tb IIIC T85°C/100°C Db IP66 | Max. 600V, 110A | IP66 |
| JB790 | ⊕ II 2GD Ex e IIC T6/T5 Gb; Ex e ia IIC T6/T5 Gb; Ex ia IIC T6/T5 Gb Ex tb IIIC T85°C/100°C Db IP66 | Max. 600V, 110A | IP66 |

| Enclosure size | | Max. entry quantity | | | | | | |
|----------------|--------------|---------------------|-------------|-----|-----|-----|----------|-------------|
| | | 150 | 195 | 360 | 560 | 790 | 150 | 195 |
| Entry position | | Bottom | | | | | Side | |
| PF & NPT | 1/2" (16C) | 2 | 3 | 10 | 26 | 34 | 2 | 2 |
| | 3/4" (22C) | 2 | 2 | 10 | 24 | 30 | 1 | 2 |
| | 1" (28C) | 1 | 2 | 7 | 12 | 18 | 1 | 1 |
| | 1-1/4" (36C) | Max. 1" | 1 | 5 | 11 | 16 | Max. 1" | 1 |
| | 1-1/2" (42C) | - | Max. 1-1/4" | 3 | 9 | 4 | - | Max. 1-1/4" |
| | 2" (54C) | - | - | 2 | 5 | 6 | - | - |
| METRIC | M20 | 2 | 3 | 10 | 26 | 34 | 2 | 2 |
| | M25 | 2 | 2 | 10 | 24 | 30 | 1 | 2 |
| | M32 | 1 | 2 | 7 | 12 | 18 | 1 | 1 |
| | M40 | Max. M32 | 1 | 5 | 11 | 16 | Max. M32 | 1 |
| | M50 | - | Max. M40 | 3 | 9 | 4 | - | Max. M40 |
| | M63 | - | - | 2 | 5 | 6 | - | - |

| | | | | | |
|-------|--|-----|---|---|----|
| JB150 | Rated Cross Section (mm ²) | 2.5 | 4 | 6 | 10 |
| | Max. Qty | 12 | 8 | 7 | 6 |

| | | | | | | |
|-------|--|-----|----|----------------|---------------|---------------|
| JB195 | Rated Cross Section (mm ²) | 2.5 | 4 | 6 | 10 | 16 |
| | Max. Qty | 15 | 12 | 8(V), 10(H) | 6(V), 7(H) | 4(V), 5(H) |

* V : Vertical row, H : Horizontal row

* This information is only used for reference purpose.

Above quantity can be changed in accordance with certificate.

| | | | | | | | |
|-------|--|------|------|----|----|----|----------------|
| JB360 | Rated Cross Section (mm ²) | 2.5 | 4 | 6 | 10 | 16 | 35 |
| | Max. Qty | 2x30 | 2x25 | 20 | 15 | 12 | 8(V), 10(H) |

| | | | | | | | | | |
|-------|--|------|------|------|------|------|------|-------------------|----|
| JB560 | Rated Cross Section (mm ²) | 2.5 | 4 | 6 | 10 | 16 | 35 | 50 | 70 |
| | Max. Qty | 3x50 | 3x40 | 3x30 | 2x25 | 2x20 | 2x15 | 2x12(V), 22(H) | 10 |

| | | | | | | | | | | | | | | | |
|-------|--|------|------|------|------|------|------|---------------------|-------------------|-------------------|----------------|-----------------|---------------|----------------|---------------|
| JB790 | Rated Cross Section (mm ²) | 2.5 | 4 | 6 | 10 | 16 | 35 | 50 | 70 | 95 | 120 | 150 | 185 | 240 | 300 |
| | Max. Qty | 3x88 | 3x50 | 3x50 | 3x40 | 3x30 | 3x20 | 2x20(V), 2x30(H) | 2x10(V), 20(H) | 2x10(V), 20(H) | 8(V), 12(H) | 11(V), 12(H) | 6(V), 8(H) | 9(V), 16(H) | 6(V), 8(H) |

JB GRP Junction Boxes

Drawing & Dimension

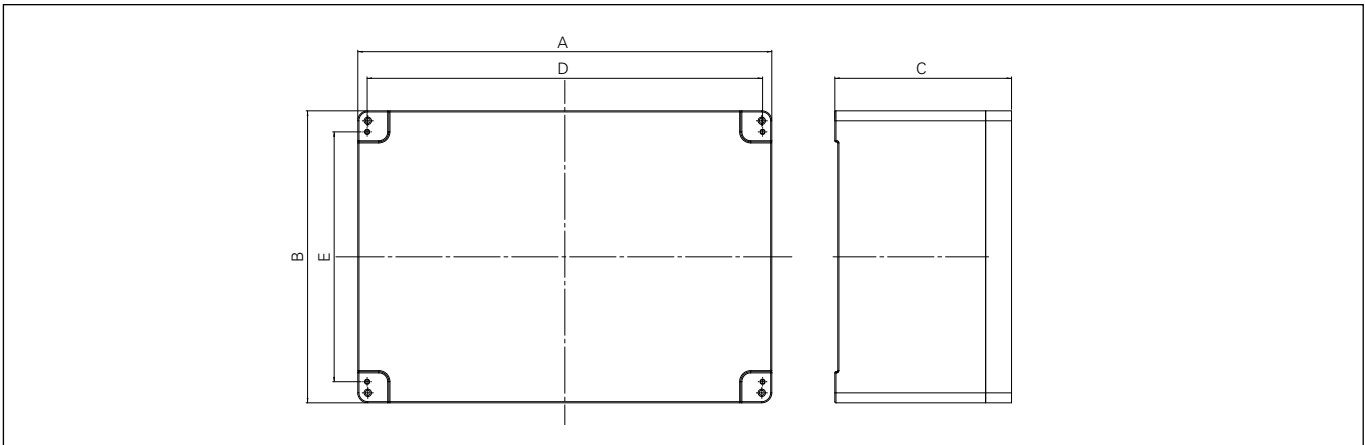

| | Box Dimension(mm) | | | Mounting Dimension(mm) | |
|-------|-------------------|-----|-------|------------------------|-----|
| | A | B | C | D | E |
| JB790 | 790 | 560 | 239 | 765 | 503 |
| JB560 | 560 | 395 | 239 | 535 | 338 |
| JB360 | 360 | 250 | 190 | 335 | 193 |
| JB195 | 195 | 140 | 116.5 | 159 | 129 |
| JB150 | 150 | 150 | 92 | 135 | 115 |

Ambient Temperature and dissipation capacity

| Temperature Class | T6 (or T85°C) | | T5 (or T100°C) | | |
|---------------------------|---------------|----|----------------|-----|-----|
| | 45 | 55 | 45 | 55 | |
| Max Amb.Temp. (°C) | | | | | |
| Maximum Power allowed (W) | JB790 | 90 | 67 | 134 | 110 |
| | JB560 | 65 | 46 | 95 | 75 |
| | JB360 | 45 | 34 | 67 | 54 |
| | JB195 | 34 | 25 | 50 | 40 |
| | JB150 | 33 | 24 | 48 | 38 |