

2.10

Ex-Intermediate Motor Terminal Boxes

up to 240 mm² Plastic version for Zone 1 and Zone 21

2

Connecting drives

The CEAG connection and junction boxes are used in Zones 1, 2, 21 and 22 as junction boxes for the connection of pumps, heating, motordrives etc. in hazardous explosion endangered areas.

The connection and junction boxes are fitted with certified terminals accommodating for 240 mm² according to EN 60079. For larger terminal cross sections, versions with terminal bolts are also used.

A special version with terminal rails accommodating for 240 mm² and a double cable end box enables the connection of larger terminal cross sections. The cable to be connected is put through the front side and is laid into the double cable terminal box where it is then connected to the terminal bolts on the copper rail.

The terminal boxes are fitted with trumpet shaped cable glands and a strain relief or just a strain relief for a flexible cable outlet.



Features

- Decisive cost reduction with the CEAG mounting system using junction boxes accommodating for 70 mm²
- With four cables, connections of up to 240 mm² possible
- Mechanical, chemical and thermal durability



Type 791 02

Technical data

Type 791 02	
Marking accd. to 2014/34/EU	⊕ II 2 G Ex e IIC T5/T6 Gb / ⊕ II 2 D Ex tb IIIC T80°C Db
EC-Type Examination Certificate	BVS 16 ATEX E 031
IECEX Certificate of Conformity	IECEX BVS 16.0024
Marking accd. to IECEx	Ex e IIC T5/T6 Gb Ex tb IIIC T80°C Db
Permissible ambient temperature	-20 °C to +40 °C / -55 C to +55 °C (option)
Rated voltage	up to 690 V
Rated current	depends on terminal mounting
Degree of protection accd. to EN 60529	IP66
Enclosure material	Polyamide
Terminal cross section	up to 6 mm ²
Weight	approx. 0.7 kg

Ordering details

Type	Cable gland	No. of terminals	Order No.
Type 791 02 assembled with screw terminals 2 x 4 mm² + 1 x PE-terminals 2 x 4 mm²			
Ex-e	1 x M25 cable gland 1 x M32 trumpet-shaped gland Ø 15-20 mm	4 x Ex-e 1 x PE	GHG 791 0201 R0016

Other versions for cable Ø 15 - 20 mm available on request.

Accessories

Type	Application	Fixing method	Order No.
Mounting plate for intermediate motor terminal box 791 02			
Size 2	Wall mounting	snap on	GHG 610 1953 R0104
Size 2	Trellis mounting	snap on	GHG 610 1953 R0106
Size 2	Pipe clamp	snap on	GHG 610 1953 R0105
Protective canopy size 2	for mounting plate size 2		GHG 610 1955 R0102

Dimension drawing

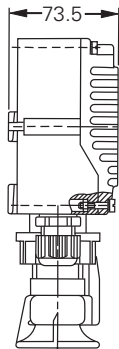
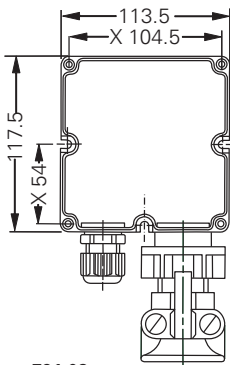

Type 791 02

X = fixing dimensions

GHG 721 Ex-intermediate motor terminal boxes 10 mm²/16 mm²



Type 721 00 10 mm²



Type 721 00 16 mm²

Technical data

Type 721 00

Marking accd. to 2014/34/EU	⊕ II 2 G Ex e IIC T4/T5/T6 Gb / ⊕ II 2 D Ex tb IIIC T80 °C/T95 °C IP6X
EC-Type Examination Certificate	BVS 13 ATEX 013X
IECEX Certificate of Conformity	IECEX BVS 13.0031X
Marking accd. to IECEx	Ex e IIC T4/T5/T6 Ex tb IIIC T80 °C/T95 °C Db IP6X
Permissible ambient temperature	-20 °C to +40 °C
Rated voltage	up to 690 V
Rated current	depends on terminal mounting
Degree of protection accd. to EN 60529	IP66
Terminal cross section	max. 10 mm ² / max. 16 mm ²
Enclosure material	glass-fibre reinforced polyester
Weight	721 00 approx. 1.0 kg / 721 10 approx. 1.1 kg

Ordering details

Type	Cable gland	No. of terminals	Order No.
Type 721 00 assembled with screw terminals 2 x 10 mm² + 1 x PE-terminals 2 x 10 mm²			
Ex-e	1 x M40 cable gland 1 x M40 trumpet-shaped gland Ø 19-27 mm	4 x Ex-e 1 x PE	GHG 721 0001 R0013
Type 721 00 assembled with screw terminals 2 x 16 mm² + 1 x PE-terminals 2 x 16 mm²			
Ex-e	1 x M50 Ø 21-35 mm 1 x M50 trumpet-shaped gland Ø 26-34 mm	4 x Ex-e 1 x PE	GHG 721 0001 R0014

Other applications available on request.

Accessories

Type	Application	Fixing method	Order No.
Mounting plate for intermediate motor terminal box 721 00			
Size 2A	Wall mounting	snap on	GHG 610 1953 R0107
Size 2A	Trellis mounting	snap on	GHG 610 1953 R0109
Size 2A	Pipe clamp	snap on	GHG 610 1953 R0108
Protective canopy size 2A	for mounting plate size 2A		GHG 610 1955 R0103

Dimension drawing

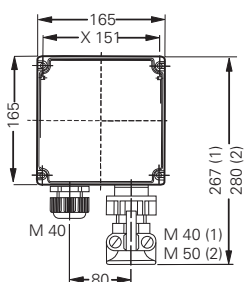

Type 721 00

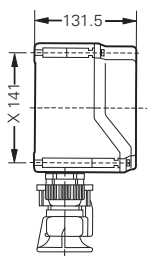

Dimensions in mm



Type 745 02

Technical data

Type 745 02	
Marking accd. to 2014/34/EU	⊕ II 2 G Ex e IIC T4/T5/T6 Gb / ⊕ II 2 D Ex tb IIIC T80 °C/T95 °C Db IP6X
EC-Type Examination Certificate	BVS 12 ATEX E 118X
IECEX Certificate of Conformity	IECEX BVS 12.0071X
Marking accd. to IECEx	Ex e IIC T4/T5/T6 Gb Ex tD tb III T80 °C/T95 °C Db IP6X
Permissible ambient temperature	-20 °C to +40 °C
Rated voltage	up to 690 V
Rated current	depends on terminal mounting
Degree of protection accd. to EN 60529	IP66
Enclosure material	glass-fibre reinforced polyester
Terminal cross section	up to 35 mm ² or max. 70 mm ²
Weight	745 0201 R0002 approx. 3.0 kg / 745 0201 R0003 approx. 3.2 kg

Ordering details

Type	Cable gland	No. of terminals	Order No.
Type 745 02 assembled with screw terminals 2 x 35 mm² + 1 x PE-terminals 2 x 35 mm²			
Ex-e	1 x M50 Ø 21-35 mm 1 x M63 trumpet-shaped gland Ø 35-46 mm	4 x Ex-e 1 x PE	GHG 745 0201 R0002
Type 745 02 assembled with screw terminals 2 x 50/70 mm² + 1 x PE-terminals 2 x 50/70 mm²			
Ex-e	1 x M50 Ø 21-35 mm 1 x M63 trumpet-shaped gland Ø 35-46 mm	4 x Ex-e 1 x PE	GHG 745 0201 R0003

Other applications available on request.

Accessories

Type	Application	Fixing method	Order No.
Mounting plate for intermediate motor terminal box 745 02			
Size 3	Pipe clamp	screwless mounting on 2 plates	GHG 610 1953 R0108
Protective canopy size 3	for mounting plate size 3		GHG 610 1955 R0104

Dimension drawing

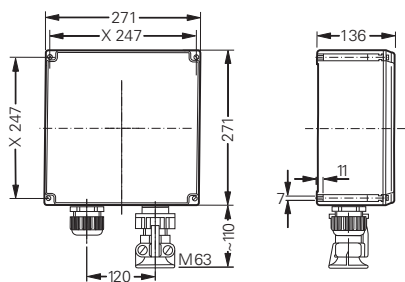

Type 745 02

X = fixing dimensions

GHG 746 Ex-intermediate motor terminal boxes 185 mm²/240 mm²



GHG 746 0301 R0001



GHG 746 0301 R0020

Technical data

Type 746 03

Marking accd. to 2014/34/EU	⊕ II 2 G Ex e IIC T4/T5/T6 Gb / ⊕ II 2 D Ex tb IIIC T80 °C/T95 °C Db IP6X
EC-Type Examination Certificate	BVS 12 ATEX E 118X
IECEX Certificate of Conformity	IECEX BVS 12.0071X
Marking accd. to IECEx	Ex e IIC T4/T5/T6 Gb Ex tD tb III T80 °C/T95 °C Db IP6X
Permissible ambient temperature	-20 °C to +40 °C
Rated voltage	up to 690 V
Rated current	depends on terminal mounting
Degree of protection accd. to EN 60529	IP54
Cable gland	via double cable pothead
Enclosure material	glass-fibre reinforced polyester
Terminal cross section	up to 180 mm ² or max. 240 mm ²
Weight	746 0301 R0001 approx. 6.3 kg / 746 0301 R0008 approx. 16.5 kg

Ordering details

Type	Cable gland	No. of terminals	Order No.
Type 746 03 assembled with bold clamp 2 x 185 mm² + PE-bold clamp 2 x 185 mm²			
Ex-e	Double cable pothead 1 x entry sleeve 21-45 mm 1 x entry sleeve 46-72 mm	3 x Ex-e 1 x PE	GHG 746 0301 R0001
Type 746 03 assembled with bold clamp 240 mm² + PE-bold clamp 240 mm²			
Ex-e	Double cable pothead 2 x entry sleeve 46-72 mm	6 x Ex-e 2 x PE	GHG 746 0301 R0008
Type 746 03 assembled with bold clamp 240 mm² + PE-bold clamp 240 mm²			
Ex-e	Double cable pothead 3 x entry sleeve 46-72 mm	12 x Ex-e 4 x PE	GHG 746 0301 R0020

Other applications available on request.



GHG 746 0301 R0020



GHG 746 0301 R0001

Dimension drawing

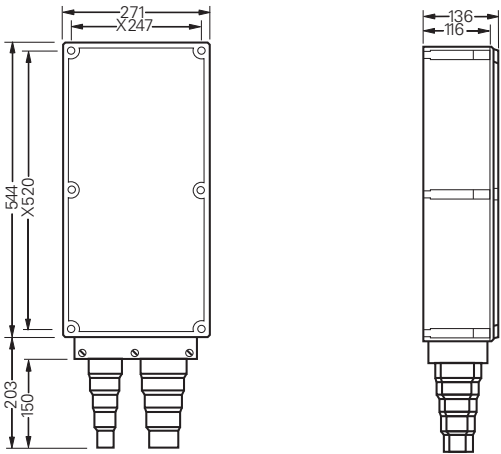

GHG 746 0301 R0001

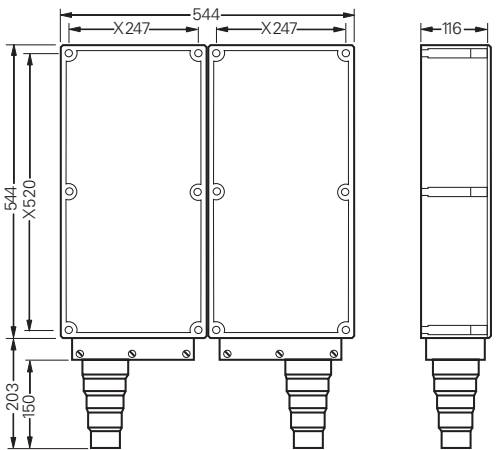

GHG 746 0301 R0008

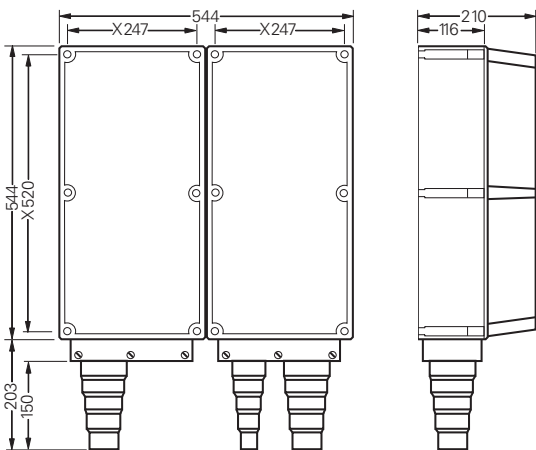

GHG 746 0301 R0020

X = fixing dimension